

01

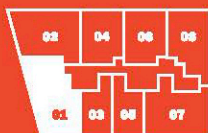
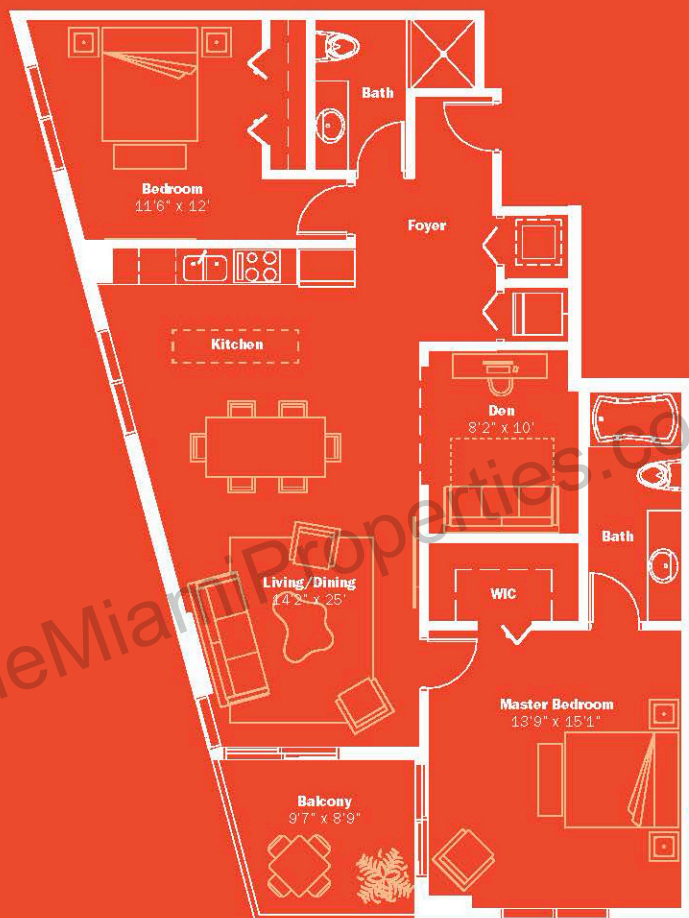

2 Bedrooms + 2 Bathrooms + Den

AC: 1,220 SQ. F. | Balcony: 86 SQ. F.

TOTAL SQ. F.: 1,306 | TOTAL M²: 121.33

* TERRACE INCLUDED

Stated dimensions are measured to the exterior boundaries of the exterior walls and the centerline of interior dividing walls and do not vary from the dimensions that would be determined by using the description and definition of the Unit set forth in the Declaration, which generally only includes the interior airspace between the perimeter walls and excludes interior structural components. For your reference, the area of the Unit, determined in accordance with those defined unit boundaries, is +/- 1,140 sq. ft. Note that measurements of rooms set forth on this floor plan are generally taken at the greatest point of each given room (as if the room were a perfect rectangle), without regard for any alcove. Accordingly, the area of the actual room will typically be smaller than the product obtained by multiplying the stated height, linear width. All dimensions are approximate and may vary with actual construction, and all floor plans and development plans are subject to change.

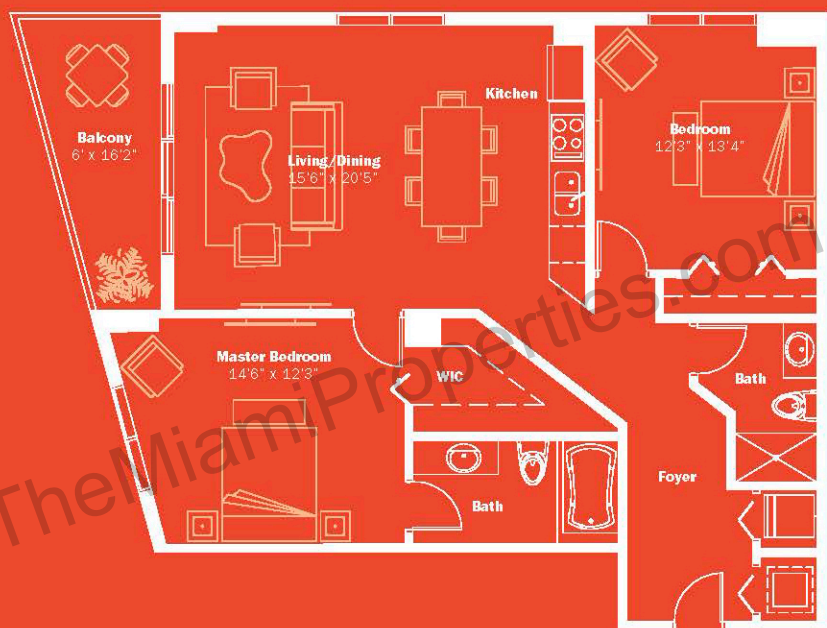

2 Bedrooms + 2 Bathrooms

AC: 1,135 SQ. F. | Balcony: 100 SQ. F.

TOTAL SQ. F.: 1,235 | TOTAL M²: 114.73

* TERRACE INCLUDED

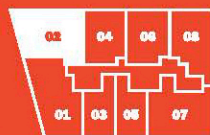

Stated dimensions are measured to the exterior boundaries of the exterior walls and the centerline of exterior openings with eaves. Rectify from this dimension that would be determined by using the designation and definition of the Unit set forth in the Declaration (which generally only includes the interior airspace between the perimeter walls and excludes interior structural components). For your reference, the area of the Unit, determined in accordance with those defined unit boundaries, is +/- 1,045 sq. ft. Note that measurements of rooms set forth on this floor plan are generally taken at the greatest points of each given room (as if the room were a perfect rectangle), without regard for any alcove. Accordingly, the area of the actual room will typically be greater than the product obtained by multiplying the stated length times width. All dimensions are approximate and may vary with actual construction, and all floor plans and development plans are subject to change.

03

05

as shown but reversed

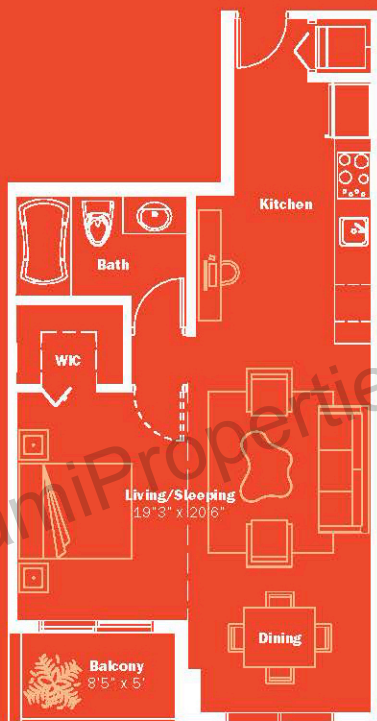

Studio + 1 Bathroom

AC: 600 SQ. FT. | Balcony: 42 SQ. FT.

T SQ. FT.: 642 | T M²: 59.64

* TERRACE INCLUDED

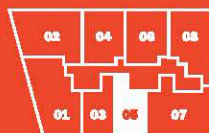

Stated dimensions are measured to the exterior boundaries of the exterior walls and the centerline of exterior opening walls and not the very front dimension that would be determined by using the description and division of the "Unit" set forth in the Declaration which generally only includes the interior airspace between the perimeter walls and/or other interior structure components. For your reference, the area of the Unit, determined in accordance with these defined unit boundaries, is 401 - 666 sq. ft. for units 02-05. Note that measurements of rooms set forth on this floor plan are generally taken at the greatest points of each given room (as if the room were a perfect rectangle), without regard for any columns. Accordingly, the area of the actual room will typically be smaller than the product obtained by multiplying the stated height, floor width. All dimensions are approximate and may vary with actual construction, and all floor plans and development plans are subject to change.

04

06

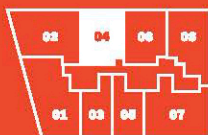
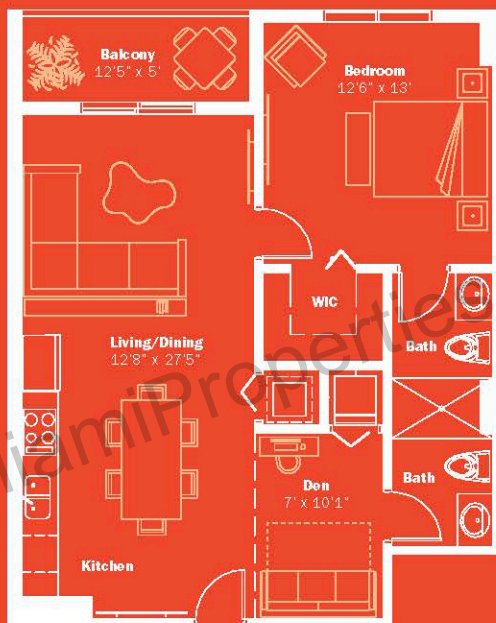

1 Bedroom + 1 1/2 Bath + Den

AC: 790 SQ F | Balcony: 62 SQ F

TOTAL SQ F*: 852 | T M²*: 79.15

* TERRACE INCLUDED



Stated dimensions are measured to the exterior boundaries of the selected walls and the centerlines of interior partitioning walls and do not vary from the dimensions that would be determined by using the description and division of the Unit set forth in the Declaration (which primarily only includes the interior space between the perimeter walls and structural interior components). For your reference, the area of the Unit, determined in accordance with those stated unit boundaries, is 852 sq. ft. for units 04 & 06. Note that measurements of rooms set forth on this floor plan are generally taken at the greatest points of each given room (as if the room were a perfect rectangle), without regard for any corners. Accordingly, the area of the actual room will typically be smaller than the product obtained by multiplying the stated length times width. All dimensions are approximate and may vary with actual construction, and all floor plans and development plans are subject to change.

07

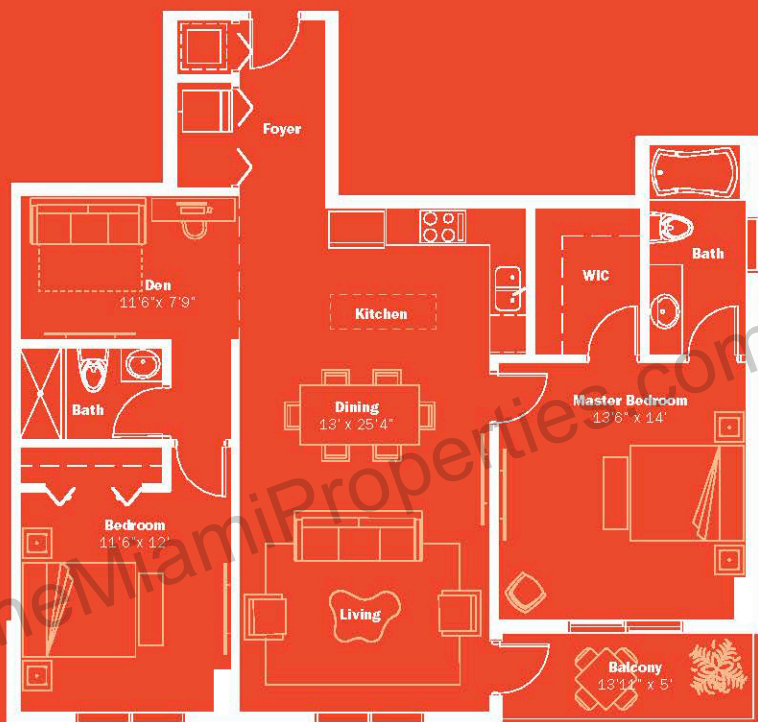

2 Bedrooms + 2 Bathrooms + Den

AC 1,195 SQ F | Balcony: 70 SQ F

TOTAL SQ F*: 1,265 | TOTAL M²*: 117.52

* TERRACE INCLUDED

Stated dimensions are measured to the exterior boundaries of the exterior walls and the centre of entrance opening walls and do not vary from the dimensions that would be determined by using the description and definition of the Unit set forth in the Declaration, which generally only includes the interior airspace between the perimeter walls and excludes interior structural components. For your reference, the area of the Unit, determined in accordance with those defined unit boundaries, is + or - 1.15 sq ft. Note that measurements of rooms set forth on this floor plan are generally taken at the greatest points of each given room (as if the room were a perfect rectangle), without regard for any alcove. Accordingly, the area of the actual room will typically be smaller than the product obtained by multiplying the stated height, floor width, and dimensions are approximate and may vary with actual construction, and all floor plans and development plans are subject to change.

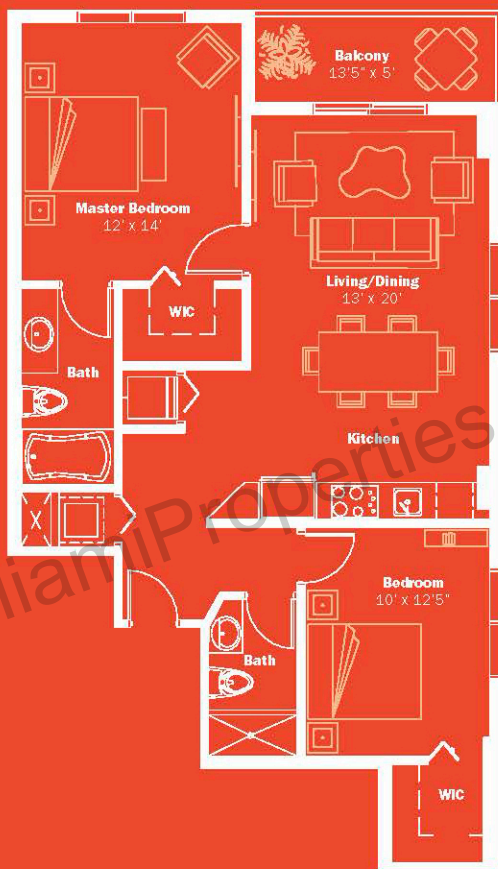

2 Bedrooms + 2 Bathrooms

AC 955 SQ. FT. | Balcony: 67 SQ. FT.

TOTAL SQ. FT.: 1,022 | TOTAL M²: 94.94

* TERRACE INCLUDED

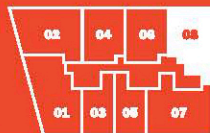

Stated dimensions are measured to the exterior boundaries of the exterior walls and the centerline of exterior doors and windows. Accuracy from this dimension will be determined by using the designation and definition of the Unit set forth in the Declaration (which generally only includes the interior airspace between the perimeter walls and excludes interior structural components). For your reference, the area of the Unit, determined in accordance with those defined unit boundaries, is ± 4 or ± 0.5 sq. ft. Note that measurements of rooms set forth on this floor plan are generally taken at the greatest points of each given room (as if the room were a perfect rectangle, without regard for any outliers). Accordingly, the area of the actual room will typically be smaller than the product obtained by multiplying the stated length times width. All dimensions are approximate and may vary with actual construction, and all floor plans and development plans are subject to change.